

Par of Jaws	Part no	For spring Ø from	For spring Ø up to	Weight
KL-9001-16 SP	52659	55mm inside	120mm outside	3,8 kg
KL-9001-17 SP	52664	85mm inside	155mm outside	4,4 kg
KL-9001-12 SP	52660	105mm inside	170mm outside	3,9 kg
KL-9001-17 SP Volvo	52658	85mm inside	155mm outside	4,4 kg

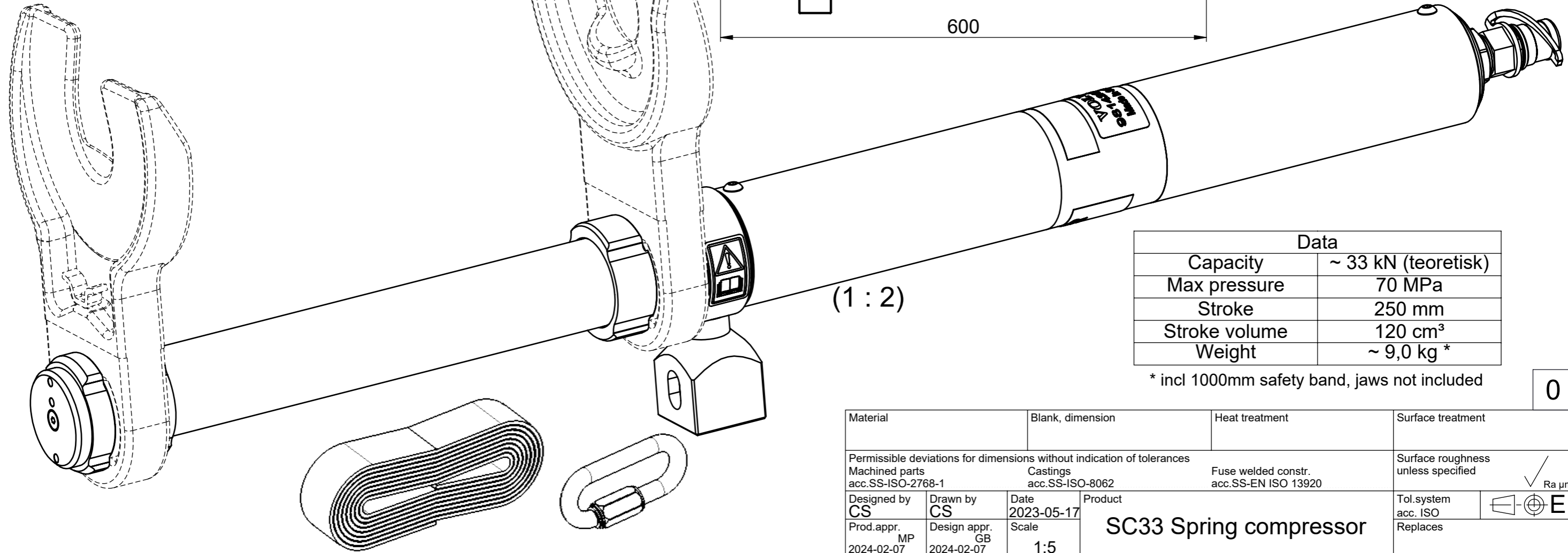
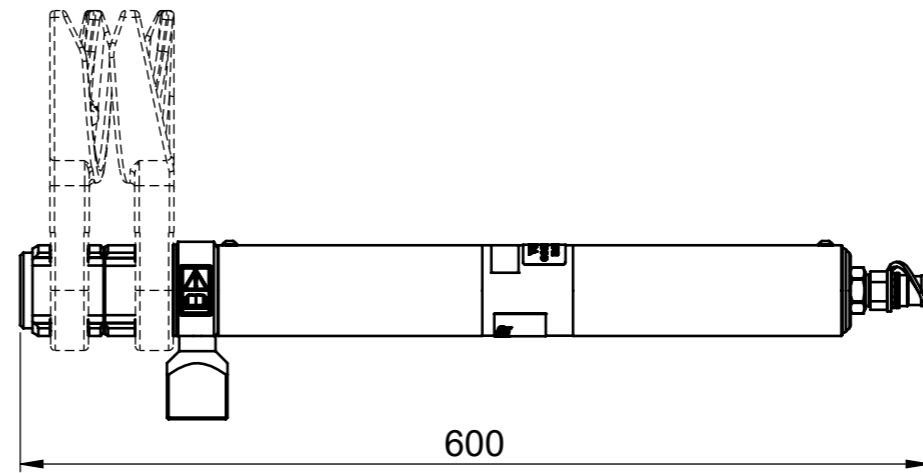

Data	
Capacity	~ 33 kN (teoretisk)
Max pressure	70 MPa
Stroke	250 mm
Stroke volume	120 cm <sup>3</sup>
Weight	~ 9,0 kg *

\* incl 1000mm safety band, jaws not included

Material		Blank, dimension		Heat treatment		Surface treatment	
Permissible deviations for dimensions without indication of tolerances		Machined parts acc.SS-ISO-2768-1		Castings acc.SS-ISO-8062		Fuse welded constr. acc.SS-EN ISO 13920	
Designed by CS	Drawn by CS	Date 2023-05-17	Product SC33 Spring compressor		Tol.system acc. ISO		<input checked="" type="checkbox"/> Ra $\mu$ m <input type="checkbox"/> E
Prod.appr. MP 2024-02-07	Design appr. GB 2024-02-07	Scale 1:5	Title Dimension drawing		Replaces		
				Replaced by		C-52636	

DENNA RITNING ÄR REHOBOT AB:s EGENDOM. SKYDDAD ENLIGT GÄLLANDE LAG. THIS DRAWING IS THE PROPERTY OF REHOBOT AB. PROTECTED BY PREVAILING LAW.

Issue	Change	Position	Date	Sign.
8		7		6