

FEATURES OF THE DO111A

- Quick and easy to use
- 86 mm stroke
- 13 ton capacity
- Spring return
- Equipped with a male quick coupling as standard
- Works in any position, horizontal or vertical



Hydraulic door opener **DO111A**

The door opener DO111A is the perfect tool for rescue and police where forced entry operations are necessary.

■ Information



Place the DO111A in position, apply pressure by pumping the hydraulic pump until the door breaks open. The tool can work in any position, horizontal or vertical which makes the DO111A quick and easy to use.

■ Functionality



The DO111A is provided with a flat surface, which enables the tool to be hammered in to the door slot. Furthermore, it has serrated teeth for holding a steady grip between the door and frame.

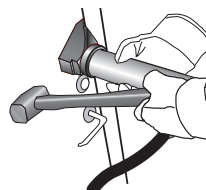

■ Usability



Fields of use where the DO111A is applicable may include:

- Rescue services
- Civil defence
- Emergency aid operations

DO111 - PERFORMANCE

Capacity		Max working pressure		Stroke		Stroke volume	
kN	ton	MPa	psi	mm	inch	cm ³	in ³
127	13	80	11603	86	3.4	136	8.3

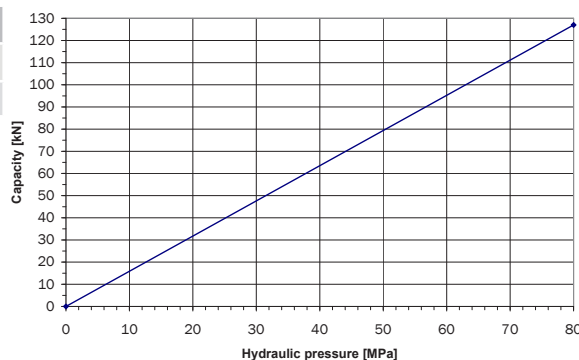

DO111A - MEASUREMENTS & DATA

A		B		C		D		E		F		G		H		I		Weight	
mm	inch	mm	inch	mm	inch	mm	inch	mm	inch	mm	inch	mm	inch	mm	inch	mm	inch	kg	lbs.
208	8.189	120	4.724	57,1	2.248	25	0.984	86	3.4	1	0.039	19	0.748	89	3.504	100	3.94	5.1	11.2

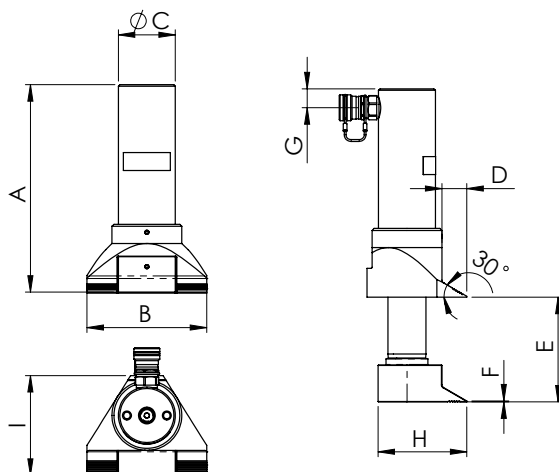

DO111A - PUMP ALTERNATIVES

Hand pump	Rescue hand pump for hand or foot operations
<p>PHS80-300 (2-stage) PHS80-300W (2-stage, without gauge) PH80A-600 (single-stage, without gauge)</p>	<p>PHS80-2400R (2-stage)</p>

Hose not included, please contact REHOBOT for further information.

ORDERING INFORMATION

Designation	D0111A			
Part number	51680			
Designation	PHS80-300	PHS80-2400R	PHS80-300W	PH80A-600
Part number	44412	44879	44881	49102